

Florence Co. - August 29, 2023
 NPDES Permit NOI
 Scale 1" = 1,355' (Approximate)

Blue Water Industries, LLC
Salem-Henry Tract Sand Mine

Pamplico South, Prospect
 Crossroads, Gresham,
 Johnsonville 7.5' USGS
 Topographic Quad Maps

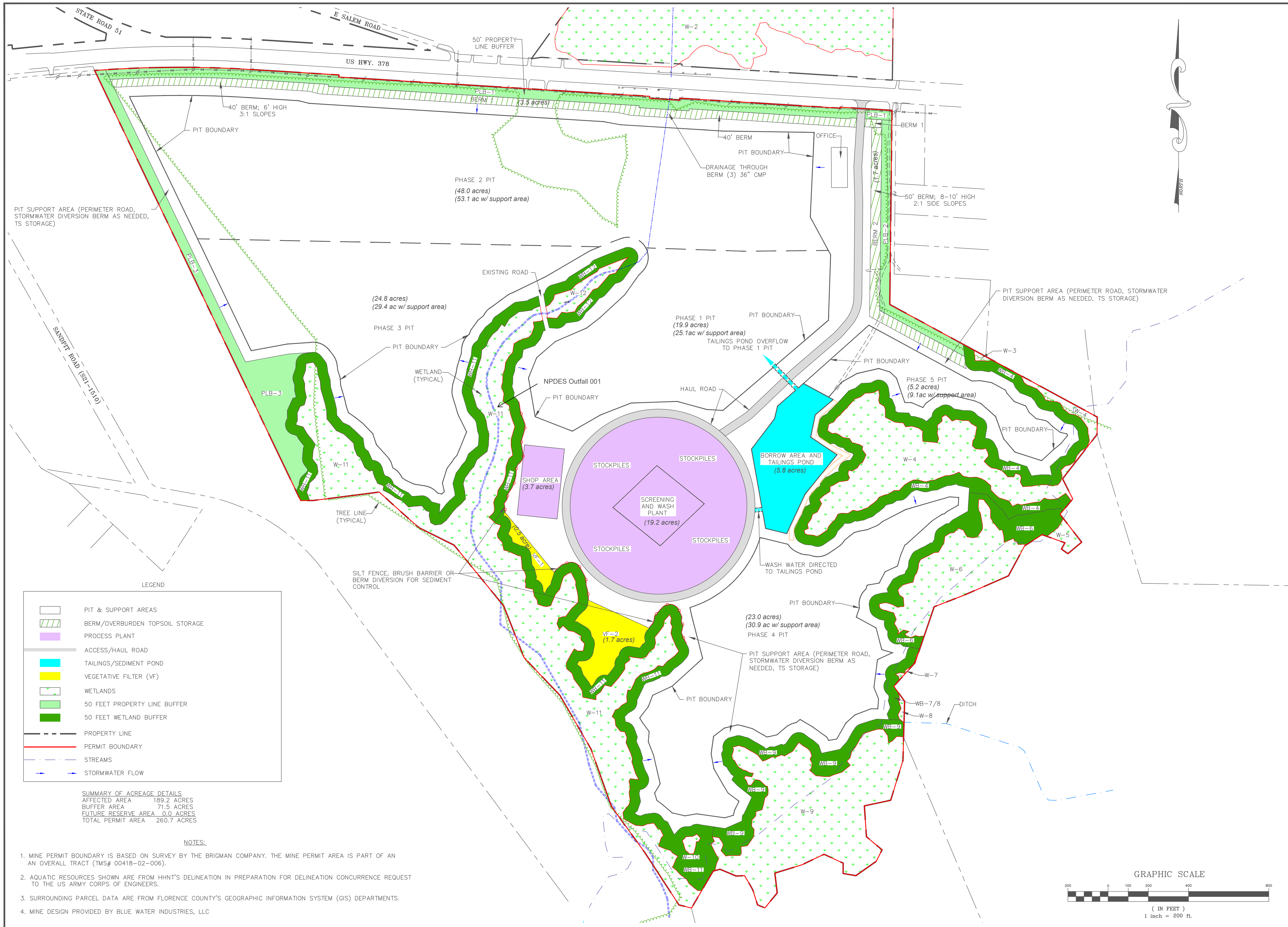

LEGEND

- PIT & SUPPORT AREAS
- BERM/OVERBURDEN TOPSOIL STORAGE
- PROCESS PLANT
- ACCESS/HAUL ROAD
- TAILINGS/SEDIMENT POND
- VEGETATIVE FILTER (VF)
- WETLANDS
- 50 FEET PROPERTY LINE BUFFER
- 50 FEET WETLAND BUFFER
- PROPERTY LINE
- PERMIT BOUNDARY
- STREAMS
- STORMWATER FLOW

SUMMARY OF ACREAGE DETAILS

AFFECTED AREA	189.2 ACRES
BUFFER AREA	71.5 ACRES
FUTURE RESERVE AREA	0.0 ACRES
TOTAL PERMIT AREA	260.7 ACRES

- NOTES:**
1. MINE PERMIT BOUNDARY IS BASED ON SURVEY BY THE BRIGMAN COMPANY. THE MINE PERMIT AREA IS PART OF AN OVERALL TRACT (TMS# 00418-02-006).
 2. AQUATIC RESOURCES SHOWN ARE FROM HNHT'S DELINEATION IN PREPARATION FOR DELINEATION CONCURRENCE REQUEST TO THE US ARMY CORPS OF ENGINEERS.
 3. SURROUNDING PARCEL DATA ARE FROM FLORENCE COUNTY'S GEOGRAPHIC INFORMATION SYSTEM (GIS) DEPARTMENTS.
 4. MINE DESIGN PROVIDED BY BLUE WATER INDUSTRIES, LLC

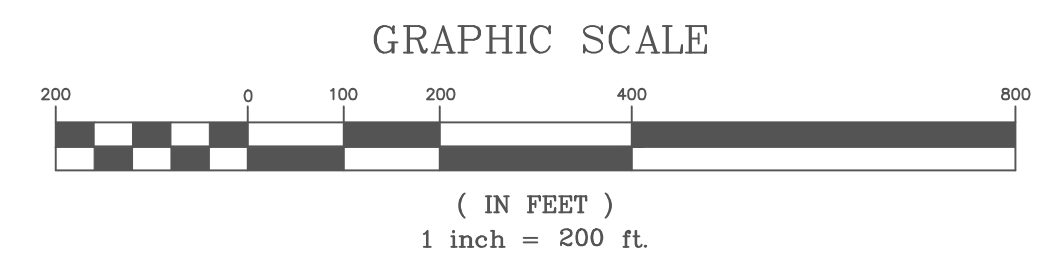

REVISIONS

Date	By	Description

Kennedy Consulting Services, LLC
 Craig Kennedy, P.G.
KCS
 Office: 403 Seaside Court, Lexington, SC 29072 | Call: 803.960.2562
 Mail: P.O. Box 364, Irmo, SC 29063 | Email: craigkennedy@kcs@gmail.com

Salem Sand-Henry Tract Mine Mine Map
 Prepared for **Blue Water Industries, LLC**
 Florence County - South Carolina

Project No.: KCS 22-174
 Date: 07-27-23
 Approved by: RCK
 Drawn by: B.C.
 Scale: 1"=200'

Sheet No. 1 of 2